

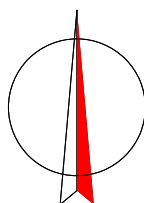

Aleš Kala



ČÍSLO OVĚŘENÍ 124/2024

DATUM 30.9.2024

NÁLEŽITOSTMI A PŘESNOSTÍ ODPOVÍDÁ
PRÁVNÍM PŘEDPISŮM

VYTYČIL	ING. FILIP ROSA			GEOTOP GEODETICKÉ PRÁCE, TERMOVIZE, MĚŘENÍ RADONU GEOTOP ROSA s.r.o. LIBUŠINO ÚDOLÍ 122, BRNO IČ: 04614771, DIČ: CZ04614771 MAIL: ROSA@GEOTOP.CZ MOBIL: 602512710, URL: WWW.GEOTOP.CZ
VYPRACOVAL	ING. FILIP ROSA			
OVĚŘIL	ING. ALEŠ KALA			
ČÍSLO ZAKÁZKY	124/2024	DATUM VYTYČENÍ	9/2024	
SOUŘADNICOVÝ SYSTÉM	JTSK, BPV	MĚŘÍTKO	1:1000	
KAT. ÚZEMÍ	Rohle	OBEC	Rohle	OKRES Šumperk

OBJEDNATEL TALPA-VHS, s.r.o., Holčevkova 36, 718 00 Ostrava - Kunčičky

AKCE **DOKUMENTACE GEODETICKÉHO VYTYČENÍ STAVBY**

VÝKRES
Realizace PSZ v k.ú. Rohle - I. etapa
SO-01 LBK2 A MOKŘADY M1 A M2, SO-02 ROHELNICE A IP3, SO 03 Rohelka a IP1, SO 04 LB Rohelka a tůň T1



Padělky

1794

1795

1796

1799

1797

1821

208

1452/2

1803

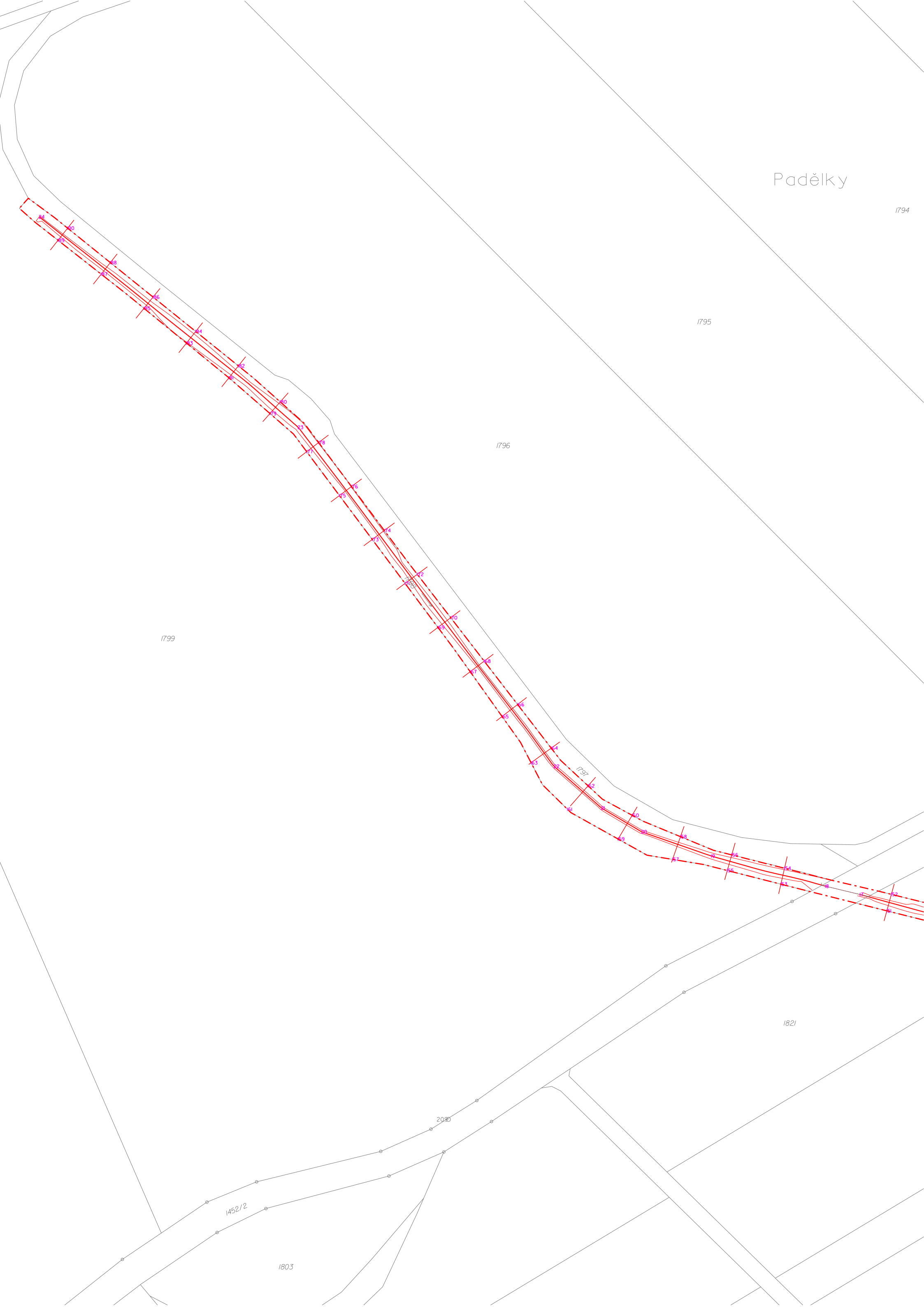

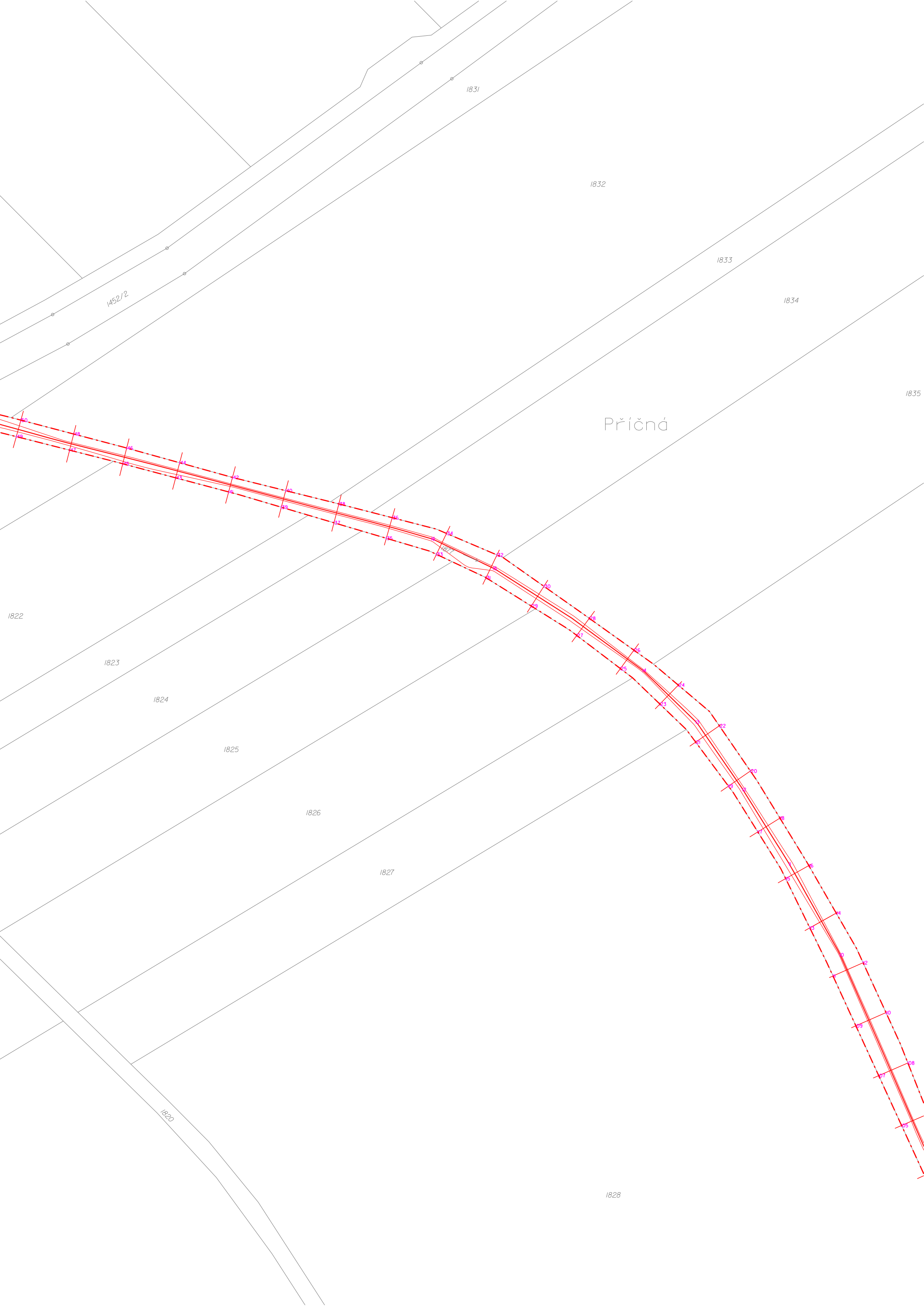

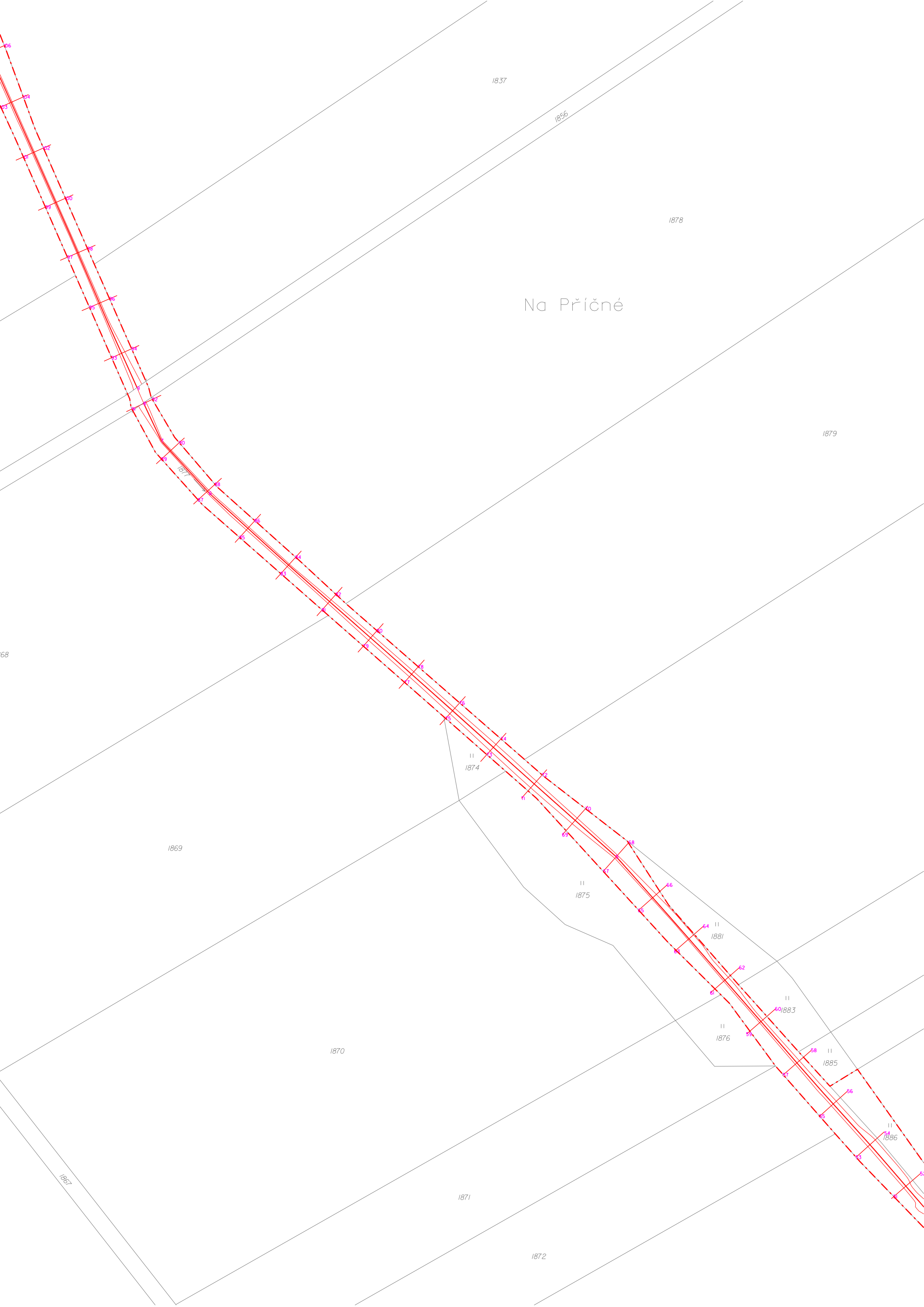

Na Příčné

1837

1856

1878

1879

1868

1869

11
1874

11
1875

11
1881

11
1883

11
1876

1870

11
1885

11
1886

1867

1871

1872

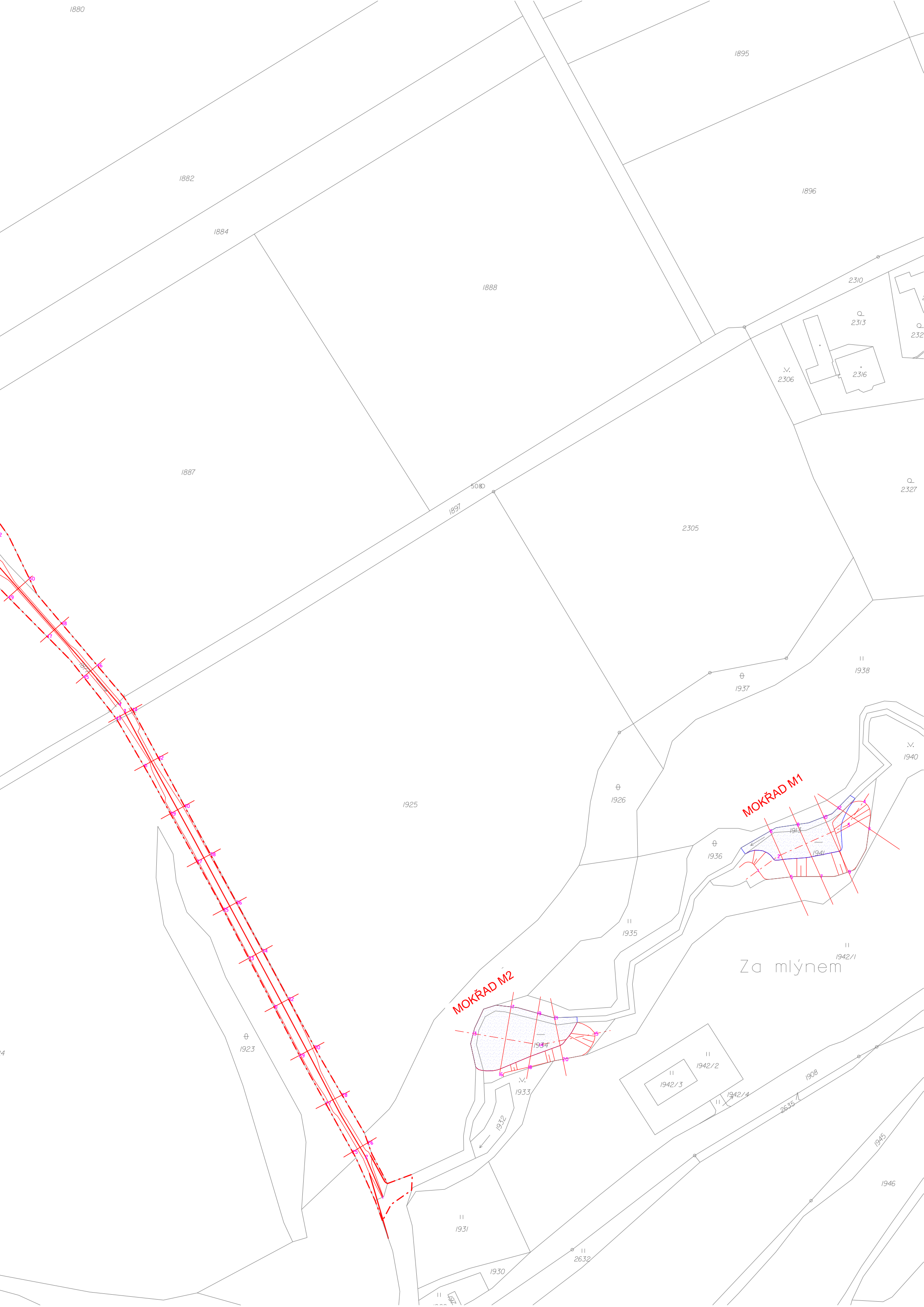

1880

1895

1882

1896

1884

1888

2310

2313

2316

2306

2327

1887

5080

2305

1897

2327

1938

1937

1925

1926

MOKŘAD M1

1936

1940

1935

Za mlýnem

1942/1

MOKŘAD M2

1923

1942/2

1942/3

1942/4

1933

1908

2635/1

1945

1931

1946

1930

2632

1933

SEZNAM SOUŘADNIC

=====

Bod	Y	X
10001	561167.216	1090853.313
10002	561160.064	1090848.126
10003	561134.610	1090836.720
10004	561128.838	1090828.206
10005	561155.391	1090855.644
10006	561162.880	1090838.932
10007	561144.505	1090855.484
10008	561153.000	1090836.525
10009	561134.301	1090853.800
10010	561143.285	1090833.751
10011	561126.852	1090837.998
10012	561138.083	1090830.383
10013	561271.172	1090912.756
10014	561246.840	1090916.890
10015	561226.772	1090912.817
10016	561261.563	1090927.643
10017	561257.384	1090903.041
10018	561250.973	1090925.009
10019	561247.609	1090905.392
10020	561238.473	1090922.135
10021	561241.545	1090906.998
20001	561304.150	1090972.440
20002	561310.397	1090957.711

20003	561398.603	1090795.120
20004	561400.370	1090792.696
20005	561555.948	1090615.251
20006	561704.322	1090482.646
20007	561721.868	1090463.478
20008	561728.271	1090449.913
20009	561730.603	1090444.385
20010	561811.166	1090261.333
20011	561829.726	1090228.177
20012	561846.688	1090201.043
20013	561863.739	1090176.369
20014	561883.136	1090157.590
20015	561937.587	1090120.366
20016	561960.141	1090109.594
20017	562140.838	1090061.487
20018	562153.477	1090058.444
20019	562195.040	1090047.469
20020	562220.542	1090038.601
20021	562235.152	1090029.918
20022	562252.424	1090014.729
20023	562345.822	1089891.054
20024	562440.230	1089814.330
20025	561315.193	1090955.915
20026	561309.608	1090952.583
20027	561324.967	1090938.278
20028	561319.003	1090935.162
20029	561334.572	1090920.756

20030	561329.014	1090917.804	20057	561495.022	1090694.790
20031	561343.833	1090903.029	20058	561484.739	1090685.841
20032	561338.515	1090900.204	20059	561508.430	1090679.946
20033	561353.086	1090885.316	20060	561497.870	1090670.754
20034	561348.111	1090882.639	20061	561521.561	1090664.860
20035	561362.349	1090867.584	20062	561511.000	1090655.668
20036	561357.520	1090864.996	20063	561534.691	1090649.774
20037	561371.964	1090850.045	20064	561524.131	1090640.582
20038	561367.021	1090847.396	20065	561547.871	1090634.824
20039	561381.619	1090832.568	20066	561537.404	1090625.527
20040	561376.536	1090829.769	20067	561560.594	1090620.487
20041	561391.351	1090815.062	20068	561551.301	1090610.016
20042	561386.023	1090812.193	20069	561575.552	1090607.211
20043	561401.493	1090797.808	20070	561567.134	1090597.725
20044	561395.596	1090794.633	20071	561590.511	1090593.935
20045	561413.285	1090782.678	20072	561582.939	1090585.404
20046	561408.360	1090778.485	20073	561603.139	1090578.001
20047	561426.659	1090767.895	20074	561597.983	1090572.263
20048	561421.321	1090763.169	20075	561618.162	1090564.796
20049	561440.730	1090753.640	20076	561613.056	1090559.115
20050	561433.055	1090746.846	20077	561633.170	1090551.610
20051	561454.695	1090739.197	20078	561628.145	1090545.953
20052	561444.990	1090730.818	20079	561648.187	1090538.416
20053	561468.449	1090724.845	20080	561643.224	1090532.800
20054	561457.998	1090716.114	20081	561663.212	1090525.215
20055	561481.719	1090709.880	20082	561658.197	1090519.540
20056	561471.583	1090700.737	20083	561678.276	1090511.976

20084	561672.851	1090505.998	20111	561813.794	1090269.039
20085	561693.301	1090498.771	20112	561802.810	1090264.218
20086	561687.752	1090492.657	20113	561822.240	1090251.494
20087	561708.441	1090485.083	20114	561812.623	1090246.102
20088	561702.287	1090479.410	20115	561831.060	1090233.510
20089	561721.797	1090470.194	20116	561822.599	1090228.766
20090	561715.323	1090464.226	20117	561841.208	1090216.485
20091	561732.588	1090451.951	20118	561833.153	1090211.450
20092	561725.135	1090448.433	20119	561851.914	1090199.788
20093	561739.972	1090433.251	20120	561843.926	1090194.280
20094	561732.690	1090429.971	20121	561863.868	1090183.738
20095	561748.049	1090414.879	20122	561855.240	1090177.788
20096	561740.732	1090411.736	20123	561876.932	1090169.862
20097	561756.098	1090396.570	20124	561870.223	1090162.947
20098	561748.788	1090393.430	20125	561891.329	1090156.915
20099	561764.127	1090378.309	20126	561886.404	1090150.218
20100	561756.830	1090375.065	20127	561907.260	1090144.820
20101	561772.177	1090360.000	20128	561902.680	1090138.593
20102	561764.852	1090356.744	20129	561923.825	1090134.104
20103	561780.414	1090341.784	20130	561919.227	1090126.914
20104	561772.191	1090338.109	20131	561940.339	1090123.776
20105	561788.775	1090323.562	20132	561936.341	1090115.472
20106	561779.122	1090319.375	20133	561958.426	1090115.239
20107	561797.118	1090305.380	20134	561954.755	1090107.613
20108	561786.475	1090300.764	20135	561976.724	1090109.392
20109	561805.452	1090287.219	20136	561974.577	1090101.884
20110	561794.458	1090282.394	20137	561995.807	1090103.744

20138	561994.029	1090096.873	20165	562271.411	1089996.561
20139	562015.014	1090098.062	20166	562265.749	1089992.188
20140	562013.415	1090092.033	20167	562283.036	1089980.229
20141	562034.229	1090092.494	20168	562277.942	1089976.366
20142	562032.826	1090087.206	20169	562294.804	1089964.053
20143	562053.552	1090087.351	20170	562290.151	1089960.524
20144	562052.103	1090081.853	20171	562306.789	1089948.009
20145	562072.853	1090082.214	20172	562302.347	1089944.698
20146	562071.411	1090076.490	20173	562318.759	1089931.987
20147	562092.227	1090077.247	20174	562314.374	1089928.718
20148	562090.747	1090071.374	20175	562330.728	1089915.964
20149	562111.667	1090072.310	20176	562326.335	1089912.688
20150	562110.008	1090066.301	20177	562342.678	1089899.968
20151	562131.066	1090067.451	20178	562338.311	1089896.638
20152	562129.419	1090061.431	20179	562356.076	1089886.046
20153	562169.714	1090057.710	20180	562352.327	1089881.803
20154	562168.388	1090051.935	20181	562371.052	1089873.028
20155	562189.256	1090052.739	20182	562367.588	1089868.668
20156	562187.648	1090047.050	20183	562386.530	1089860.359
20157	562209.225	1090048.684	20184	562383.156	1089856.112
20158	562206.344	1090040.394	20185	562402.022	1089847.680
20159	562229.085	1090041.262	20186	562398.708	1089843.570
20160	562223.966	1090032.603	20187	562417.632	1089835.215
20161	562247.557	1090030.395	20188	562414.299	1089830.996
20162	562240.050	1090021.858	20189	562433.362	1089822.864
20163	562260.830	1090013.427	20190	562429.868	1089818.440
20164	562253.487	1090008.100	30001	561565.285	1089265.158

30002	561566.083	1089257.198	30029	561629.765	1088999.323
30003	561563.721	1089247.512	30030	561632.697	1088994.114
30004	561563.076	1089239.538	30031	561632.631	1088990.185
30005	561567.959	1089228.621	30032	561634.538	1088987.870
30006	561577.636	1089211.152	30033	561635.231	1088984.052
30007	561585.425	1089197.175	30034	561638.666	1088977.971
30008	561597.391	1089183.747	30035	561643.365	1088973.875
30009	561603.182	1089154.353	30036	561646.296	1088967.895
30010	561602.596	1089137.384	30037	561650.798	1088965.733
30011	561606.724	1089129.392	30038	561653.292	1088962.606
30012	561607.667	1089115.424	30039	561655.173	1088956.943
30013	561605.618	1089108.755	30040	561658.045	1088954.199
30014	561606.620	1089081.430	30041	561658.073	1088950.229
30015	561611.443	1089069.737	30042	561660.461	1088948.100
30016	561612.757	1089062.904	30043	561661.905	1088943.737
30017	561615.130	1089060.179	30044	561663.659	1088941.303
30018	561614.551	1089055.021	30045	561663.546	1088937.429
30019	561618.523	1089050.419	30046	561666.419	1088933.390
30020	561617.500	1089044.930	30047	561666.480	1088929.840
30021	561620.697	1089039.435	30048	561668.620	1088928.010
30022	561621.532	1089029.476	30049	561668.340	1088924.971
30023	561624.639	1089024.399	30050	561670.593	1088922.523
30024	561624.480	1089020.620	30051	561670.390	1088919.020
30025	561627.010	1089017.720	30052	561672.792	1088915.371
30026	561625.418	1089010.664	30053	561673.677	1088912.559
30027	561626.488	1089009.124	30054	561567.092	1089245.233
30028	561628.880	1089003.717	30055	561558.965	1089245.891

30056	561571.908	1089228.672	30083	561637.645	1088987.126
30057	561565.227	1089224.634	30084	561632.250	1088986.877
30058	561582.776	1089211.726	30085	561646.644	1088971.213
30059	561575.849	1089207.866	30086	561642.478	1088969.435
30060	561592.380	1089195.394	30087	561658.007	1088957.136
30061	561587.425	1089190.915	30088	561655.216	1088954.056
30062	561601.475	1089176.460	30089	561665.554	1088938.189
30063	561596.414	1089175.409	30090	561661.481	1088938.691
30064	561605.445	1089156.770	30091	561672.450	1088921.388
30065	561600.467	1089155.917	30092	561668.379	1088921.766
30066	561605.363	1089137.696	30093	561689.102	1088907.006
30067	561600.651	1089135.246	30094	561677.036	1088902.846
30068	561609.799	1089117.572	30095	561681.940	1088888.670
30069	561604.834	1089117.237	40001	561625.418	1089010.664
30070	561608.908	1089097.869	40002	561616.710	1089001.260
30071	561603.260	1089097.668	40003	561561.933	1088956.902
30072	561610.496	1089079.076	40004	561561.400	1088956.470
30073	561605.848	1089077.171	40005	561542.628	1088944.107
30074	561617.823	1089059.532	40006	561555.376	1088969.410
30075	561611.979	1089060.296	40007	561561.282	1088962.019
30076	561621.627	1089043.525	40008	561562.531	1088960.456
30077	561617.187	1089040.803	40009	561567.362	1088954.410
30078	561627.483	1089023.280	40010	561551.252	1088961.760
30079	561622.317	1089023.495	40011	561558.938	1088950.083
30080	561631.507	1089009.260	40012	561543.494	1088955.358
30081	561627.814	1089006.515	40013	561550.592	1088944.575
30082	561623.996	1089003.676			